

SPECIFICATIONS

- 1 BASE CONC. :- 1:5:10, CEMENT ,FINE SAND (F.M.-1.25) & 40 MM GAUGE BRICK BALLAST.
- 2 BRICK WORK :- 1:6 ,CEMENT , FINE SAND (F.M.-1.25)
- 3 D.P.C.:- 25 MM THICK IN 1:2:4,CEMENT, FINE SAND) & 20 MM GAUGE STONE GRIT WITH WATER PROOFING COMPOUND.
- 4 ROOFING :- R.C.C. 1 : 2 : 4 ,CEMENT, COURSE SAND & 20 MM GAUGE STONE GRIT WITH 8 MM DIA @ 150 C/C IN BOTH FINISHED AND RENDERED SMOOTH.
- 5:- FLOORING :- C.C. FLOORING 25 MM THICK IN 1:2:4 CEMENT ,FINE SAND , 20 MM GAUGE STONE GRIT LAID IN PANELS
- 6:- DOORS:- 30 MM THICK PVC DOOR SHUTTER FIXED WITH WALL WITH BUTT HINGES OF 4" SS OF SUITABLE SIZE.
- 7:-VENTILATOR:-PRECAST RCC JAALI 25MM THICK
- 8:- FOUNDATION FOR HALF BRICK WALL IS SAME AS ONE BRICK WALL

SCHEDULE FOR DOORS & WINDOWS				
S/N	TYPE	SIZE (MM)	SILL (MM)	LINTEL LVL (MM)
1	D1	1800 X 2100	-	2100
2	D2	750 x 1800	-	1800
3	D3	450 X 1800	-	1800
4	V- RCC JAALI	450 X 300	1800	2100
5	R.C.C.C1	230 X 230	-	-
6	R.C.C.C2	230 X 230	-	-

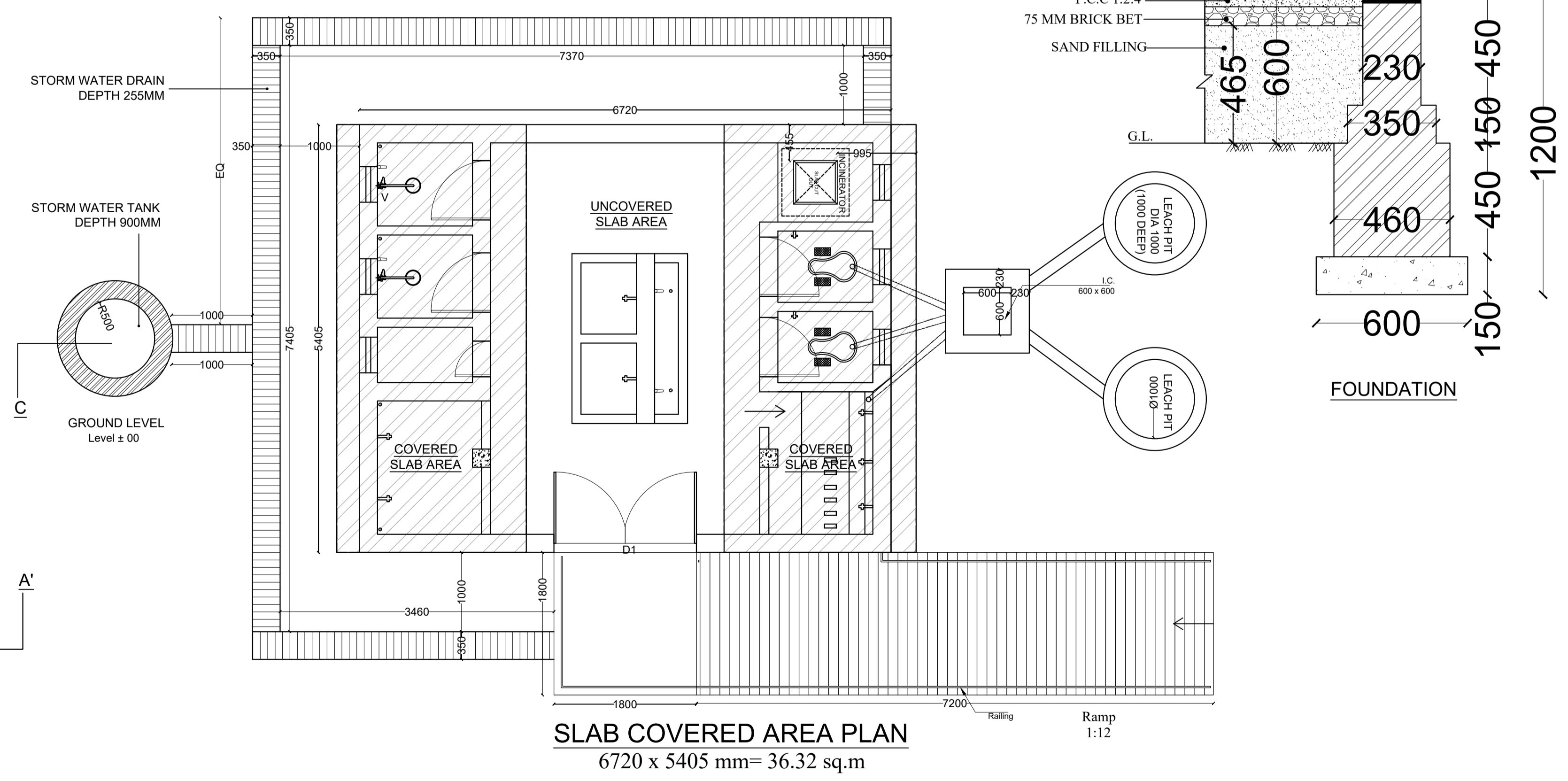
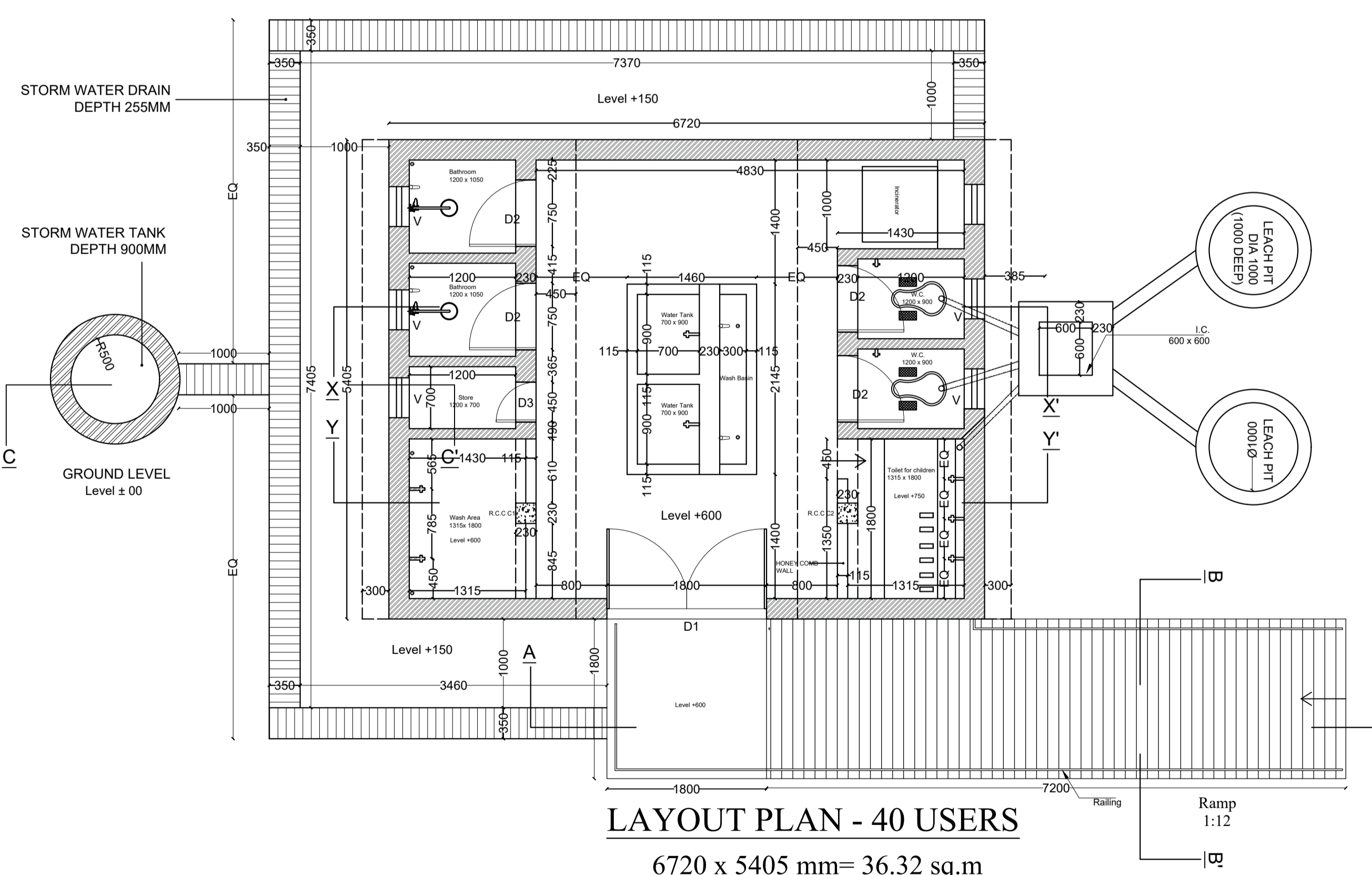
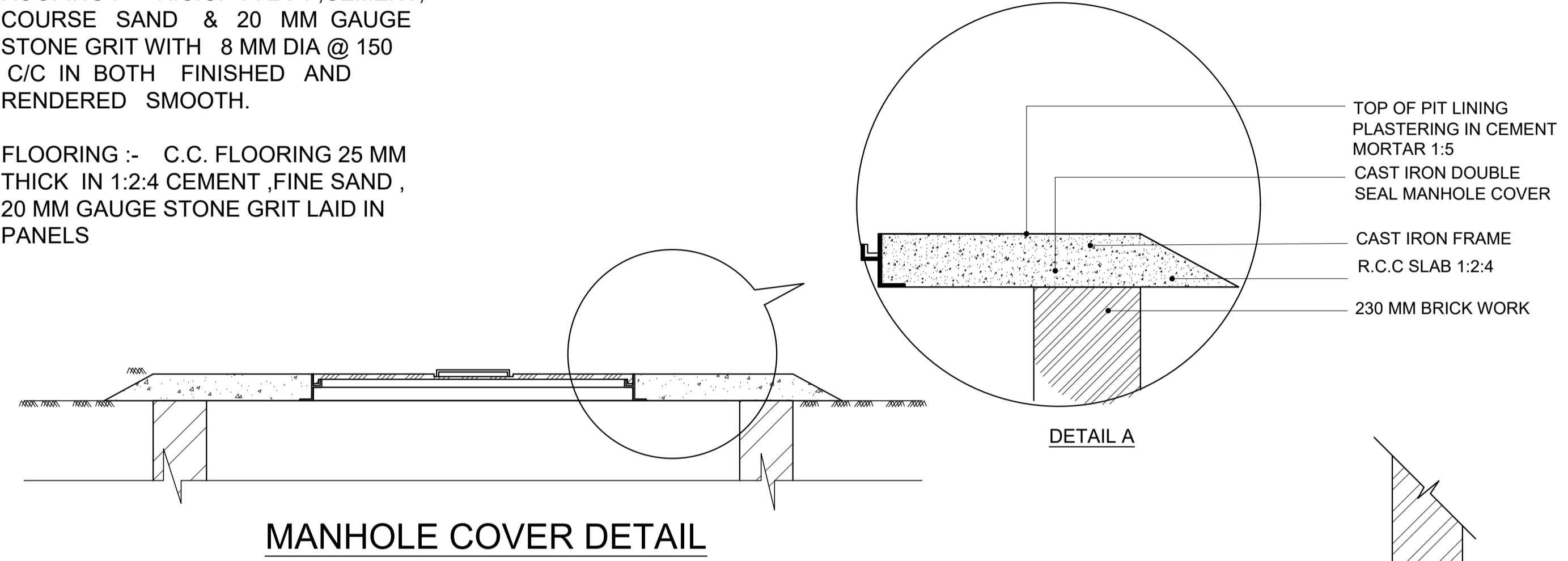

Uttar Pradesh Swachh Bharat Mission Grameen

DATE: 26/06/2020
SCALE: NOT TO SCALE (N.T.S.)

DRG. NO: R2/IDC/3.
Women & Toddlers
Sanitary Complex for 40 Users

**Uttar Pradesh State Resource Center
for Waste Management (SRC)**

ALL DIMENSIONS COVERED AREA
ARE IN MM 36.32 SQ.M

Drawn By:



इंडियन डेवलपमेंट सेंटर
INDIAN DEVELOPMENT CENTER

4th Floor, Room No. 404 & 403
Local Bodies Directorate, Plot No. 18, Sector
7, Gomti Nagar Extension, Lucknow- 226010,
Uttar Pradesh, India
connect@indevcen.org